

### 1. Installing the Brackets

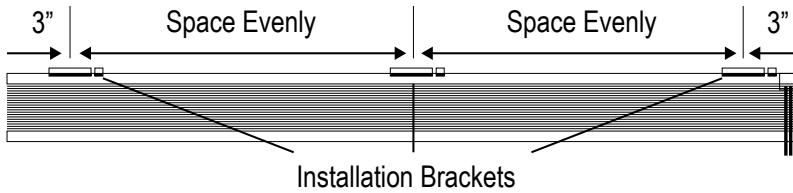

Installation Bracket Requirement Chart

Shade Width	Brackets Required
18-1/8" to 38"	2
38-1/8" to 72"	3
72-1/8" to 84"	4

Installation brackets may be used for INSIDE or OUTSIDE mounts. The bracket requirements and placements are the same for inside and outside mounts. Refer to the spacing diagram and bracket requirement chart.

**IMPORTANT:** Mounting the brackets level is essential for proper operation of the shade. Shim the brackets if necessary to achieve a level alignment.

#### 1a. Inside Mount

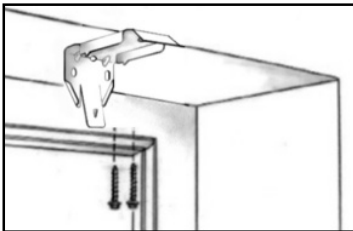

Minimum Depth	Fully Recessed
3/4"	2-1/8"

Prior to mounting the brackets, add any clearance depth required to avoid obstructions such as window cranks or handles. Refer to the mounting depth chart above. Install the brackets level and aligned to each other, using the screws provided. Ensure all brackets are level and aligned.

#### 1b. Outside Mount

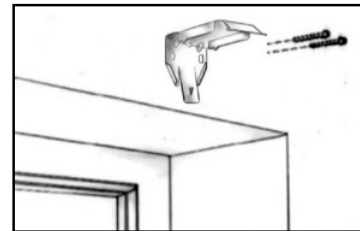

Minimum Height
1-1/2"

Install the brackets level and aligned to each other, using the screws provided. Refer to the minimum surface height chart above. Ensure all brackets are level and aligned.

### 2. Mounting the Headrail

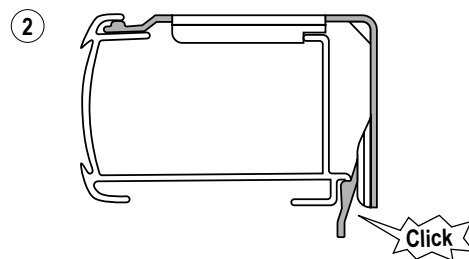
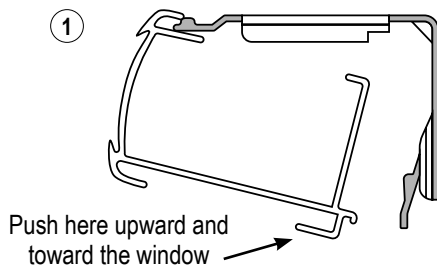

(1) With the front side of the shade facing you, tilt the headrail slightly backward to angle the front inside lip to the brackets. (2) Push the headrail back and upward to snap it into place.

**IMPORTANT:** Make sure no fabric is punched between the brackets and headrail

# INSTALLATION INSTRUCTIONS

## 3. Adjusting the Shade

Raise and lower the shade several times. If the bottom or intermediate (on Top-Down/Bottom-Up) rail is not level, use the following steps to correct.

### BOTTOMRAIL SHADE ADJUSTMENT:

- Holding the bottomrail with two hands, gently pull down on the side that is too high. Stop when the bottomrail is level.

### INTERMEDIATE RAIL SHADE ADJUSTMENT:

- Holding the intermediate rail with two hands, gently push down on the side that is too high. Stop when the intermediate rail is level.

## 4. Installing the Hold Down Brackets

(1) Lower the shade and place the hold down pins into the bottom rail end caps. (2) Mark the hold down bracket locations on the mounting surface. (3) With the brackets level, attach them using two screws.

### Outside Mount (OB)

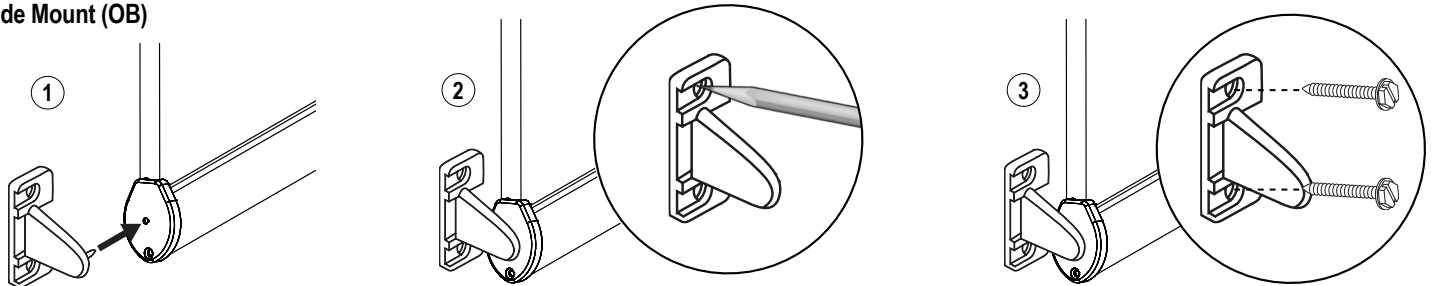

### Inside Mount (IB)

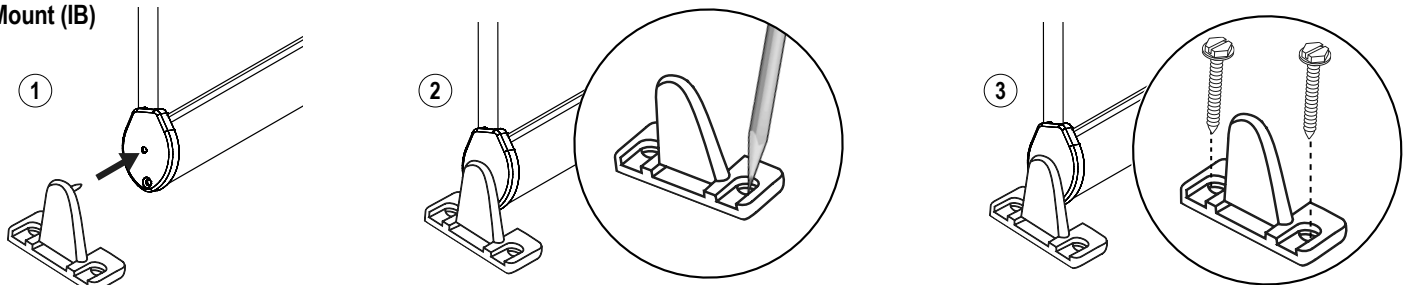

## BandLift Top Down - Bottom Up Operation

### TO RAISE AND LOWER THE SHADE:

- Hold the handle in the center portion of the bottom or intermediate rail
- Shades over 42" in width will have 2 handles evenly positioned within hands reach along the center portion of the bottom and intermediate rail to ensure level movement.
- Lower the shade by gently pulling downward to the desired position.
- Raise the shade by gently pushing upward to the desired position.

**Note:** Hold down brackets are necessary to operate the intermediate rail independently.

## Child Safety

**⚠ WARNING** STRANGULATION HAZARD –  
Young children can be strangled by cords.  
Immediately remove this product if a cord longer than 22 cm or a loop  
exceeding 44 cm around becomes accessible. Rev 7/21 Print 7/21

**⚠ MISE EN GARDE** RISQUE D'ÉTRANGLEMENT –  
Les enfants en bas âge  
peuvent s'étrangler avec des cordes. Enlevez immédiatement ce produit si une  
corde mesurant plus de 22 cm devient accessible ou si le contour d'une boucle de  
plus de 44 cm devient accessible.

**NOTE:** The No Tools Mounting System will come with the shade installation brackets already attached. No drilling is necessary to install this shade. A Flat head screwdriver is needed to remove the No Tools Mounting System.

### 1. Install the No Tools Mounting System

Make sure mounting surface is level

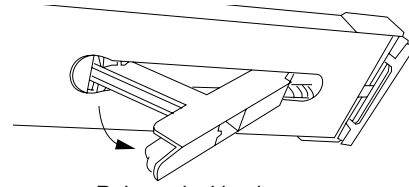
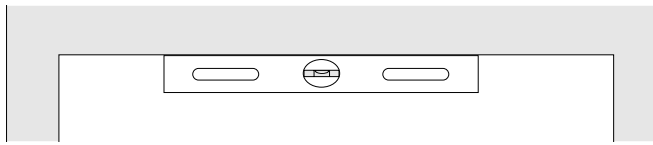

Release locking lever

### 1a. Install the No Tools Mounting System - Placement and Width Adjustment

**IMPORTANT:** If mounting on a smooth surface such as painted aluminum or tile you must apply the double sided adhesive (included) to the end caps to keep the mounting system secure. Remove release liner from one side of the adhesive and apply to both end caps and press firmly to adhere.

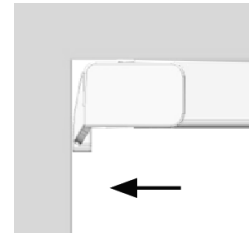
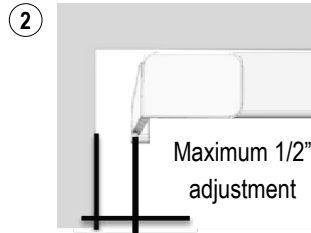
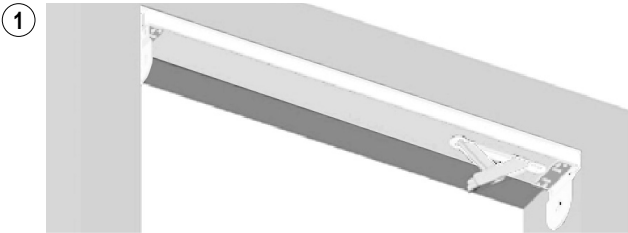

(1) Place the No Tools Mounting System in the window opening so that the end with the lever is up tight against the window casing. (2) If there is a gap at the non-lever end of the rail, simply slide the end cap until it touches the window casing. See END CAP ADJUSTMENT on page 2 if you accidentally pull the end cap out too far. If mounting on a smooth surface, remove the release liners from the double sided adhesive on the endcaps. Replace mounting system.

### 1b. Install the No Tools Mounting System - Lock in Place

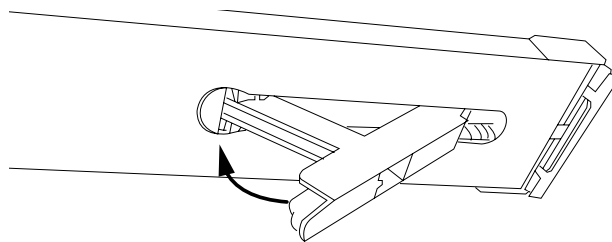

Make sure that the mounting system is level. Press up on the lever to lock the mounting system in place.

### 2. Install the Shade

Follow the instruction in the installation booklet that came with your shade to install the shade into the mounting brackets on the No Tools Mounting System.

### 3. Remove the No Tools Mounting System

**IMPORTANT:** First, remove the shade from the No Tools mounting system following the instructions in the installation booklet that came with your shade. Hold the mounting system securely with one hand. Use a flat head screwdriver to pry open the locking lever.

**CAUTION:** Lever will release abruptly. Keep hand clear of lever.

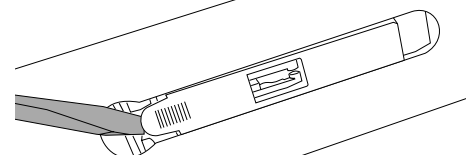

# INSTALLATION INSTRUCTIONS

## 1. Adjusting Moveable End Cap

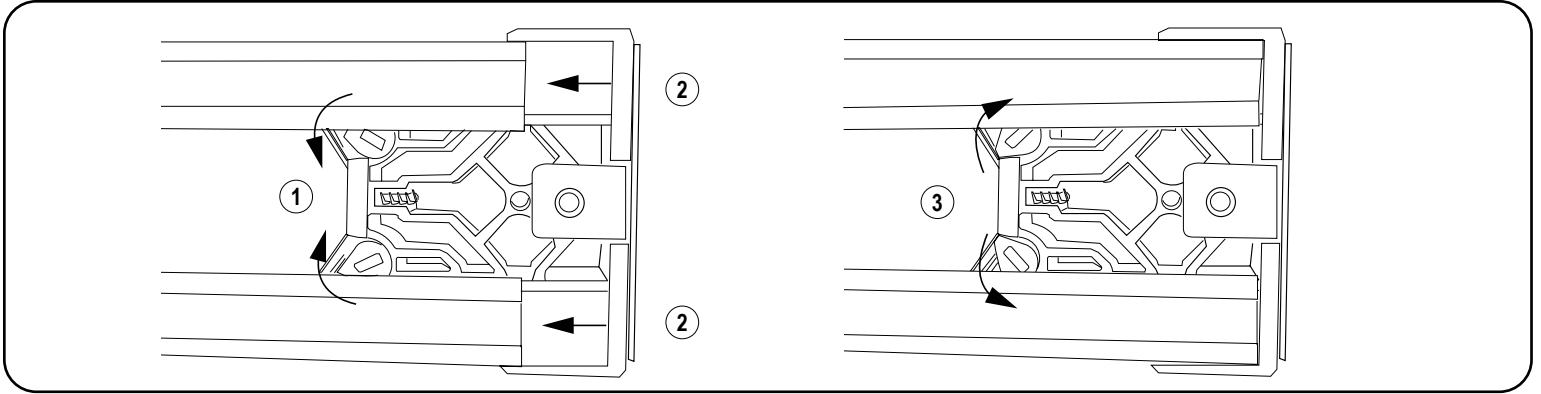

The moveable end cap is designed to only pull out with out tools. If for some reason the end cap needs to be compressed you will need a small flat head screw driver. (1) Use the screw driver to turn the locking tab release screws as shown. (2) Push the End Cap in. (3) Return the locking tabs to their original position.

## Child Safety

<b>⚠ WARNING/ADVERTENCIA</b>	
5.1.3	Rev. 5/18 Print 5/18
	Window Blind Cord Can <b>STRANGLE</b> Your Child. To prevent strangulation, purchase cordless products or products with inaccessible cords.
	La cuerda de la persiana puede <b>ESTRANGULAR</b> a su niño. Para evitar el estrangulamiento, compre alternativas cuerda o productos con cuerdas inaccesibles.